

Intel® RAID Controllers RS3DC080 and RS3DC040 Mainstream 12Gb/s SAS-3 Intelligent RAID Adapters

RAID matters. Rely on Intel® RAID.

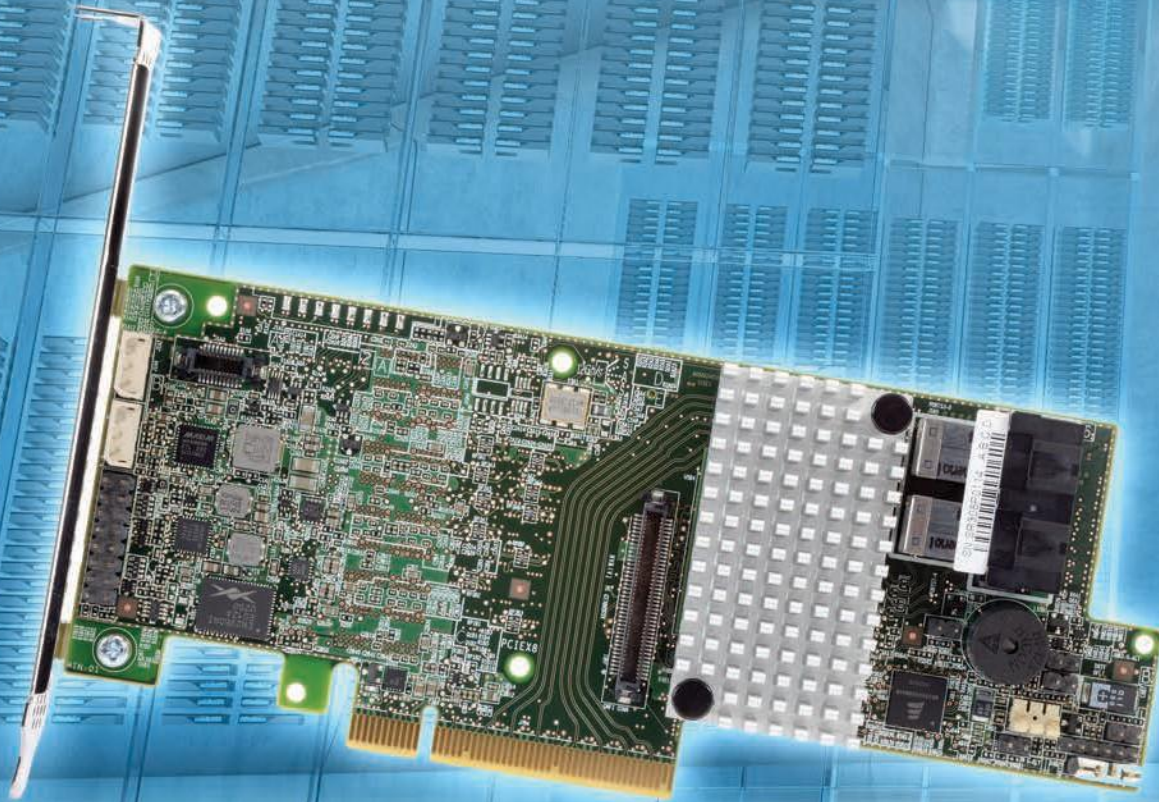

Next generation SAS 3.0 12Gb/s for enterprise-class performance and data protection.

Intel® RAID Controllers RS3DC080/040

Mainstream 12Gb/s SAS-3 Intelligent RAID Adapters

As data continues to grow at an unprecedented pace, mainstream server environments that include database servers, e-mail servers, and Web servers need a higher level of performance and scalability. Now with the Intel® RAID Controllers RS3DC080 and RS3DC040, powered by LSI® MegaRAID® Technology, organizations get next generation SAS 3.0 12Gb/s performance, enterprise-class data protection and scalability designed for mainstream server environments. Featuring more than 750K RAID 5 IOPS – more than 60 percent improvement over the previous generation – and 6,000MB/s throughput performance for streaming applications, these RAID adapters unleash the full potential of enterprise PCIe 3.0 systems.¹

The Intel® RAID Controllers RS3DC080 and RS3DC040 double the available bandwidth of current 6Gb/s SAS solutions, and offer a higher level of RAID performance and security compared to entry-level products. They feature eight and four internal ports respectively, deliver two 1.2GHz processor cores and 72-bit DDRIII interface that drives 1GB cache memory at 1866MHz. They support 8 PCI Express® lanes that comply with the latest PCI Express 3.0 specification with 8 gigatransfers per second (GT/s) per lane. Plus, each adapter supports 8 individual SAS ports operating at 12Gb/s. The adapters are backward compatible with previous PCIe and SAS generations through automatic negotiation and provide SAS data transfer rates of 12, 6, and 3Gb/s per lane, and SATA data transfer rates at 6 and 3Gb/s per lane.

The Intel RAID Web Console 2 included in these adapters enhances RAID volume creation by empowering administrators to further optimize their storage for application performance and data protection. With an intuitive graphical user interface, this Intel RAID Web Console 2 deploys all the critical system storage functions and helps eliminate complexity and learning curves. Plus, since all Intel RAID solutions are validated across multiple platforms with Intel® boards, chassis, and systems, when used together they deliver the best combination of performance, built-in.

Did you know you can enable a more than 60 percent improvement in IOPS and double the throughput of the previous generation of RAID controllers?¹



Why Intel RAID 12Gb/s controller RS3 family?

- SAS-3 compliance allows for 12Gb/s SAS performance with a 6Gb/s drive infrastructure when a SAS 3.0 expander is installed
- Provides over 6,000 Mb/s throughput performance for streaming applications and over 750K IOPS for database applications with RAID¹
- Drivers and tools supporting a wide range of Operating Systems and virtualization software
- Intel documentation and support provide ease of mind and enable low TCO

Features and Benefits

The Intel® RAID Controllers and RS3DC040, powered by LSI® MegaRAID® Technology, provides the next generation SAS 3.0 12Gb/s performance and security for mainstream server environments including database, e-mail and Web servers.

Features

1. LSI® SAS3108 ROC controller providing SAS 3.0 capability including 12Gb/s data transfer
2. Embedded 1GB 1866 MHz cache (ECC DDR3 memory) to efficiently store data in transition (Memory module included with all models, but not shown)
3. One or two HD SFF8643 SAS/SATA connectors for up to eight internal ports
4. Speaker to deliver audible alerts
5. x8 PCI Express Generation 3 interface for fast communication with the server board
6. Optional Intel® Maintenance Free Backup Unit offering cache protection with up to 5 years service life
7. Optional Intel Cable Kit AXXCBL650HDMS includes two 650mm cables with HD SFF8643 mini-SAS to 8087 mini-SAS connectors (not shown)

See table on the back page for additional information

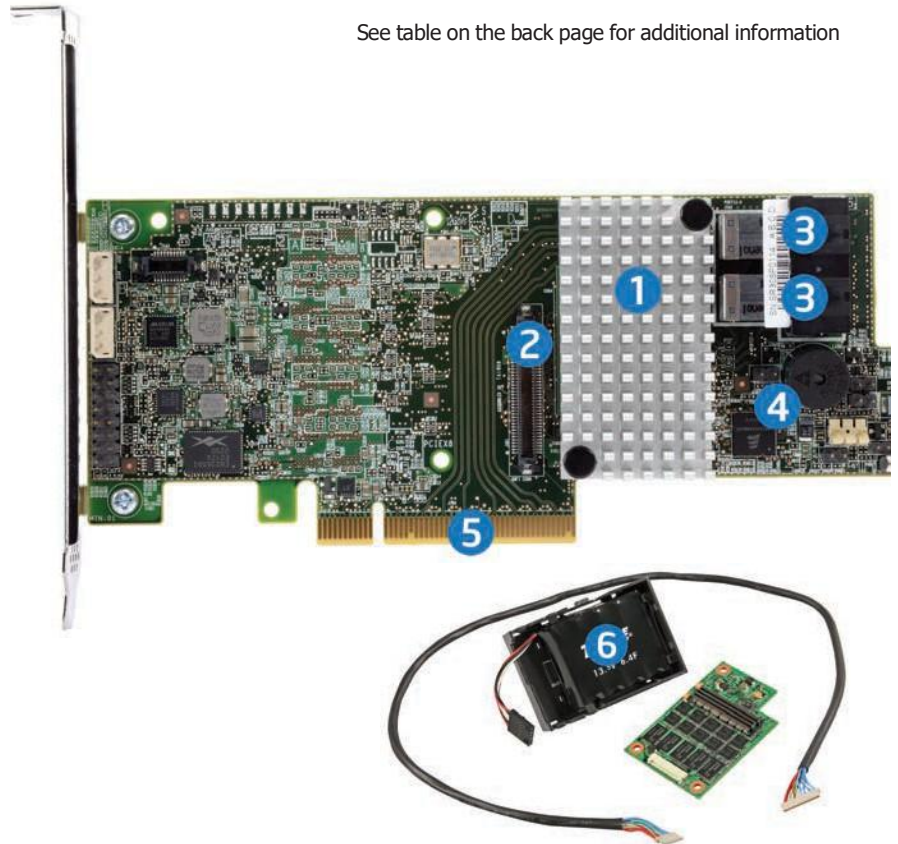

Key Advantages

- Exceptional data protection. Supports data redundancy using SAS or SATA hard disk drives through mirroring, parity, and double parity (RAID levels 1, 5, and 6) plus striping capability for spans (RAID levels 10, 50, and 60).
- Excellent performance. A dual core LSI® SAS3108 ROC, x8 PCI Express Generation 3 host interface and 1GB of 1866 MHz cache enhance the performance of mainstream applications.
- Inside-the-box design flexibility. With a true MD2 form factor, this adapter is ideal for low-profile height and half-length adapter slots. Eight internal 6 Gb/s SAS ports allow connection to 6Gb/s or 3Gb/s high-performance SAS drives, high-capacity SATA drives or a combination of both.
- Outstanding availability. Delivers proactive drive monitoring and automatic error correction. A new battery (optional accessory) offers multiple operating modes including high heat tolerance and 5 year service life options.
- FastPath I/O included. FastPath I/O – previously an add-on feature -- provides a high performance I/O accelerator for SSDs. The technology is designed to dramatically boost transactional application throughput, delivering up to 750,000 I/Os per second (IOPS) in RAID mode.
- Support for premium feature upgrades. The RS3DC080 includes a connector for optional hardware-based keys that easily plug in to unlock advanced software algorithms designed to improve performance and enhanced data protection. For instance the SSD Cache upgrade allows for using one or more SSD as enhanced cache for the RAID controller which can significantly improve performance of read-intensive applications, such as file, Web and online transaction processing servers.

Intel® RAID Controllers RS3DC080/040

Powered by LSI® MegaRAID® Technology

Technical Specifications

| | |
|------------------------------------|--|
| Order Codes | 8 Port RAID Card: RS3DC080 4 Port RAID Card: RS3DC040 MFBU (Cache backup): AXRMFBU4 Premium Feature Keys: AXRPFKSSD2, AXRPFKDE2 Cable Kits: AXXCBL650HDMS, AXXCBL730HDMS |
| RAID Levels and Spans | RAID Levels 0, 1, 5, and 6 RAID Spans 10, 50, and 60 |
| Data Protection Feature Highlights | Online Capacity Expansion Hot-Spare Support – Global & Dedicated Single Controller Multipathing (Failover) Enclosure Management Background Consistency Checking Patrol Read for Media Functionality S.M.A.R.T. Support |
| Intel® RAID Software | Intel® RAID Web Console 2 Intel® RAID Command Line Tool Intel® RAID Flash Utilities |
| Self-Encrypting Drive Support | Optional AXRPFKDE2 (Disk Encryption) upgrade key enables SafeStore* Encryption Services with Instant Secure Erase and Local Key Management |
| I/O Processor | LSI® SAS3108 ROC running at 1.2 GHz |
| Drive Types | 12Gb/s SAS, 6Gb/s SAS, 6Gb/s SATA, 3Gb/s SAS, 3Gb/s SATA |
| Maximum Drives | Up to 128 physical devices supported |
| Connectors | SFF 8643 SAS/SATA internal connectors |
| Cache Memory | Embedded 1GB DDR3 at 1866MHz |
| PCI Interface | x8 PCI Express* 3.0 |
| Cache Backup Support | Optional Intel® Maintenance Free Backup Unit AXRMFBU4 |
| Form Factor | Low profile, MD2 (6.6" X 2.536") |
| Data Transfer Rates | Up to 12Gb/s per port |
| Operating Temperature | Maximum ambient: 65°C (55°C with optional MFBU) |
| Operating Voltage | +3.3 V |

For more information on the Intel® RAID Controller RS3DC080/040, visit: www.intel.com/go/RAID

For more information on how to make the Intel® RAID Controllers RS3DC080 and RS3DC040 part of your server environment, please contact an Intel® Channel Partner Program participant.

1 - Performance tests and ratings are measured using specific computer systems and/or components and reflect the approximate performance of Intel products as measured by those tests. Any difference in system hardware or software design or configuration may affect actual performance. Buyers should consult other sources of information to evaluate the performance of systems or components they are considering purchasing.

INFORMATION IN THIS DOCUMENT IS PROVIDED IN CONNECTION WITH INTEL PRODUCTS. NO LICENSE, EXPRESS OR IMPLIED, BY ESTOPPEL OR OTHERWISE, TO ANY INTELLECTUAL PROPERTY RIGHTS IS GRANTED BY THIS DOCUMENT. EXCEPT AS PROVIDED IN INTEL'S TERMS AND CONDITIONS OF SALE FOR SUCH PRODUCTS, INTEL ASSUMES NO LIABILITY WHATSOEVER AND INTEL DISCLAIMS ANY EXPRESS OR IMPLIED WARRANTY, RELATING TO SALE AND/OR USE OF INTEL PRODUCTS INCLUDING LIABILITY OR WARRANTIES RELATING TO FITNESS FOR A PARTICULAR PURPOSE, MERCHANTABILITY, OR INFRINGEMENT OF ANY PATENT, COPYRIGHT OR OTHER INTELLECTUAL PROPERTY RIGHT.

Intel may make changes to specifications and product descriptions at any time, without notice. The information here is subject to change without notice. Do not finalize a design with this information.

Intel, the Intel logo, Intel. Leap ahead, and the Intel. Leap ahead logo are trademarks of Intel Corporation in the U.S. and other countries.

*Other names and brands may be claimed as the property of others.

Copyright © 2013 Intel Corporation. All rights reserved.

08/13/ SJ/PDF

♻️ Please Recycle

329369-001US

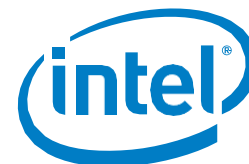

**EQUIPMENT
FOR SALE**

Intel RAID Controller RS3DC080



The Intel® RAID Controller RS3DC080 is a mainstream product powered by LSI MegaRAID technology. It offers a complete set of Intelligent RAID features.

- Crafted with a LSI3108 RAID-On-Chip (ROC) controller for exceptional performance
- Hardware RAID 0, 1, 5, 6 and Spans 10, 50, 60 allow for RAID mode flexibility. RAID 6 allows two drives to fail simultaneously while maintaining data persistence
- Advanced management tools allow for configuration optimization and superior troubleshooting



**Contact Today
For Current Inventory**

Visit TELECOMCAULIFFE.com

✓ **REDUCING LEADTIMES** ✓ **COST SAVINGS** ✓ **LIFETIME WARRANTY** ✓ **SUSTAINABLE SOLUTIONS**

PICS | **TELECOMCAULIFFE**
A PICS TELECOM TEAM

BILL MCAULIFFE
Director of Sales – National Accounts

TEAMMCAULIFFE@PICSTELECOM.COM | 585.746.6383 | TELECOMCAULIFFE.COM